

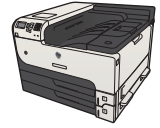

# HP LaserJet Enterprise 700 M712



## Use easy-access USB printing

This product features easy-access USB printing, so you can quickly print files from the product control panel without sending them from a computer. The product accepts standard USB flash drives in the USB port on the front of the product. You can print the following types of files:

- .pdf
- .prn
- .pcl
- .ps
- .cht

Before you can use this feature, you must enable the USB port. Use the following procedure to enable the port from the product control-panel menus:

1. On the product control panel, press the Home  button.
2. Open the following menus:
  - **Administration**
  - **General Settings**
  - **Enable Retrieve from USB**
3. Highlight the **Enable** option, and then press the **OK** button to save the selection.

Configure the following settings so the product wakes from Sleep mode whenever it receives a print job.

1. On the product control panel, press the Home  button.
2. Open the following menus:
  - **Administration**
  - **General Settings**
  - **Energy Settings**
  - **Sleep Timer Settings**
  - **Wake/Auto On Events**
3. Highlight the **All events** option and press the **OK** button.

# Print easy-access USB documents

1. Insert the USB flash drive into the USB port on the left side of the product control panel.

**NOTE:** You might need to remove the cover from the USB port.

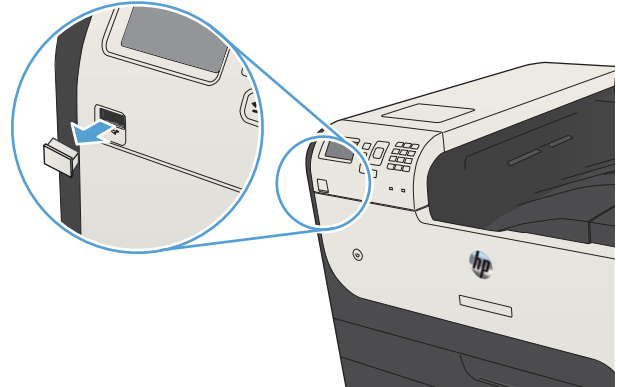

2. The **USB storage device detected** screen opens. Select the **OK** option to access the USB device.
3. Highlight the name of the document that you want to print.
4. To adjust the number of copies, use the arrow keys to change the quantity.
5. Press the **OK** button to print the document.