



## HP Color LaserJet Enterprise M651 and HP Color LaserJet Enterprise MFP M680 - Replace the toner cartridges

### Replace the toner cartridges

The product uses four colors and has a different toner cartridge for each color: yellow (Y), magenta (M), cyan (C), and black (K). The toner cartridges are inside the front door.

This product indicates when the toner cartridge level is low. The actual toner cartridge life remaining can vary. The toner cartridge does not need to be replaced at this time. Consider having a replacement cartridge available to install when print quality is no longer acceptable.

The following illustration shows the toner-cartridge components.

#### 1: Toner-cartridge components

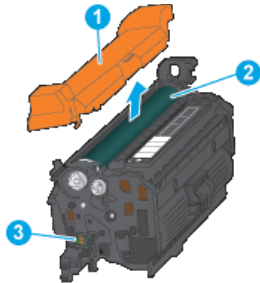

- 1 - Plastic shield
- 2 - Imaging drum
- 3 - Memory chip

---

**If toner gets on clothing, wipe it off by using a dry cloth and wash the clothes in cold water. Hot water sets toner into fabric.**

---

Information about recycling used toner cartridges is on the toner cartridge box.

---

1. Open the front door.
- 2: **Open the door**

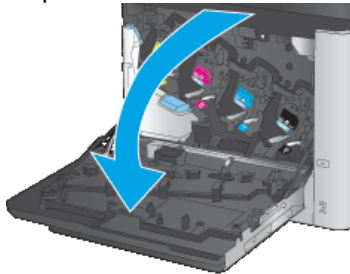

2. Grasp the handle of the used toner cartridge and pull out to remove it.
- 3: **Remove the toner cartridge**

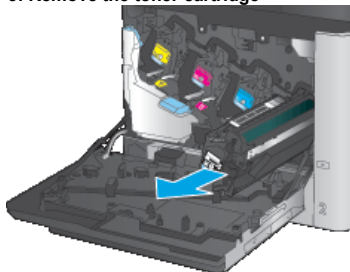

3. Remove the new toner cartridge from its protective bag.
- 4: **New toner cartridge**

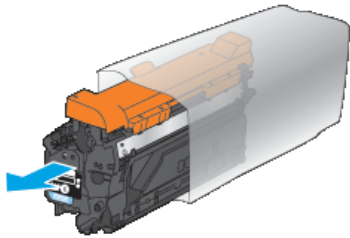

- 4. Hold both ends of the toner cartridge and rock it 5-6 times.  
**5: Shake the toner cartridge**

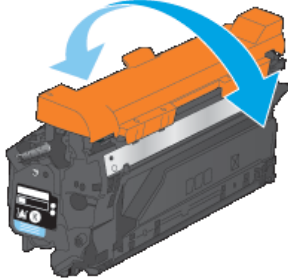

- 5. Remove the protective shield from the toner cartridge.  
**6: Remove the protective shield**

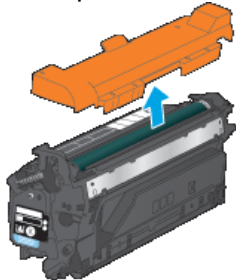

- 6. Align the toner cartridge with its slot, and then insert the toner cartridge into the product.  
**7: Install the toner cartridge**

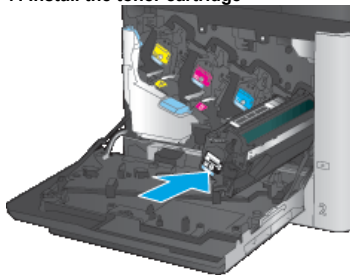

- 7. Close the front door.  
**8: Close the door**

