



LASERJET PRO 400 MFP M425 SERIES



Fax from the document feeder

1. Insert the originals into the document feeder face-up.

NOTE: The document feeder capacity is up to 50 sheets of 75 g/m² (20 lb) paper.

CAUTION: To prevent damage to the product, do not use an original that contains correction tape, correction fluid, paper clips, or staples. Also, do not load photographs, small originals, or fragile originals into the document feeder.

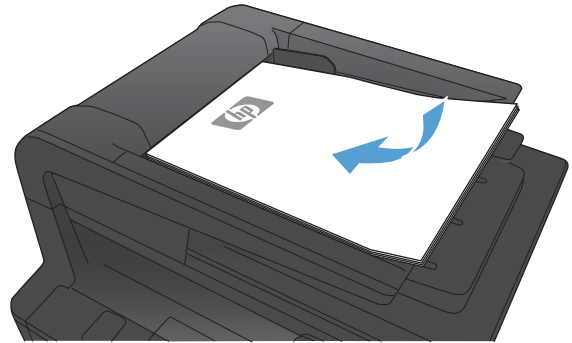

2. Adjust the paper guides until they are snug against the paper.

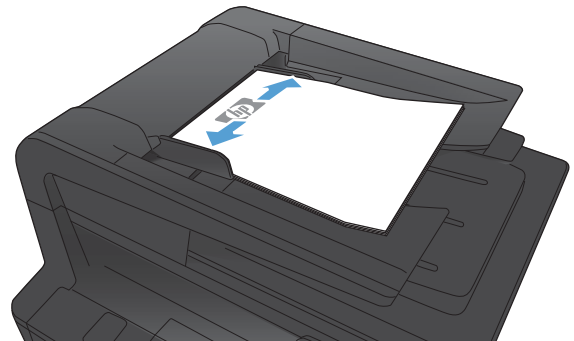

3. From the Home screen on the product control panel, touch the **Fax** button.
4. Use the keypad to type the fax number.
5. Touch the **Start Fax** button.