

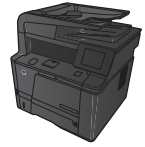

LASERJET PRO 400 MFP M425 SERIES



Copy on both sides (duplex)

1. Load the first page of the document onto the scanner glass, or load the whole document into the document feeder.

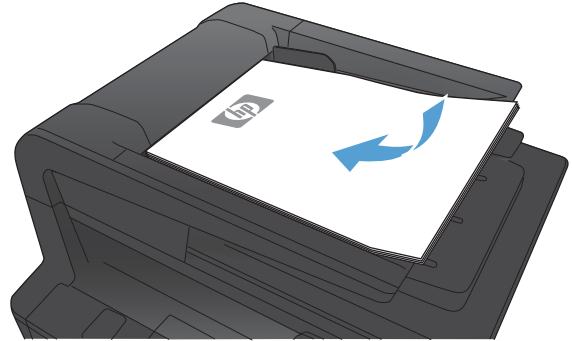

2. From the Home screen on the product control panel, touch the **Copy** button.
3. Touch the **Settings** button, and then touch the **Two-Sided** button.
4. Select the duplexing option that you want to use. For example, to copy a two-sided original with two-sided output, select the **2-Sided to 2-Sided** option.
5. Touch the **Start Copy** button to start copying.