

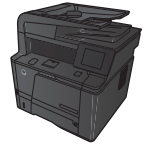

LASERJET PRO 400 MFP M425 SERIES



Collate a copy job

1. Load the document onto the scanner glass or into the document feeder.

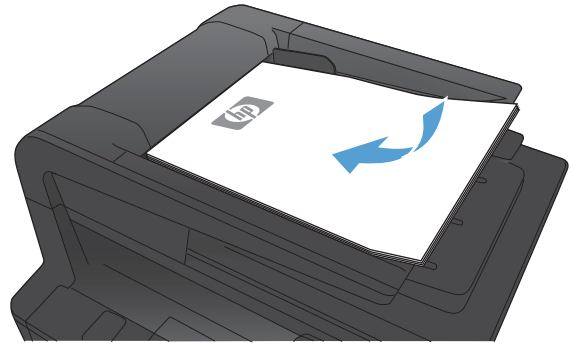

2. From the Home screen on the product control panel, touch the **Copy** button.
3. Touch the **Settings** button, and then scroll to and touch the **Collation** button. Touch the arrow buttons to scroll through the options, and then touch an option to select it.
4. Touch the **Start Copy** button to start copying.