

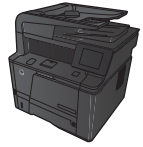

# LASERJET PRO 400 MFP M425 SERIES



## Adjust the lightness or darkness for copies

1. Load the document onto the scanner glass or into the document feeder.

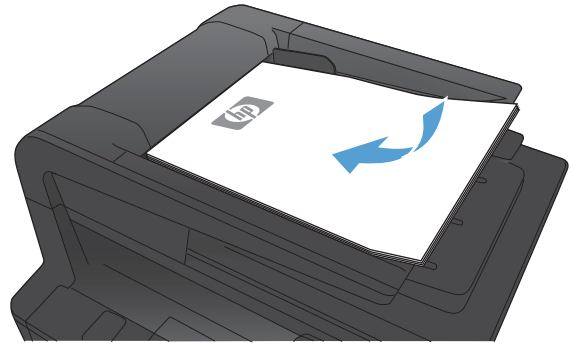

2. From the Home screen on the product control panel, touch the **Copy** button.
3. On the summary screen, touch the arrow buttons to adjust the setting.
4. Touch the **Start Copy** button to start copying.